

RECEPTACLES

KR SERIES



20 AMP 115/230 V.A.C • 1Ø 2 WIRE, 3 POLE



KRS Series



KRA



Plug

Class I, Div. 1 & 2, Groups C, D^①
Class I, Zones 1 & 2, IIB, IIA
NEMA 7 (C, D)

File No. E23572

Certified File No. LR14667

FEATURES-SPECIFICATIONS

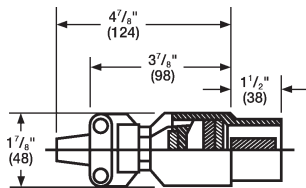

KP 20 AMP PLUG	
CATALOG NO.	DESCRIPTION
KP-20ABC	Plug furnished with 3 grommets range .250 - .625

See page PR21 for available polarization options.

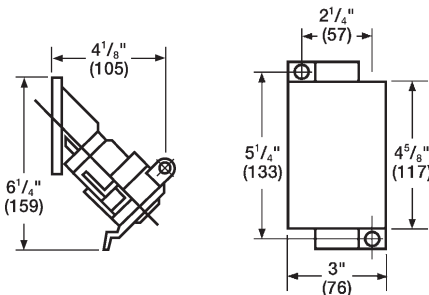

KRS-Series

KRS 20A 1Ø 2W RECEPTACLE WITH SWB BOX ^②								
HUB SIZE	CATALOG NUMBER							
	SINGLE RECEPTACLE & DEAD END BOX	BOX ONLY	SINGLE RECEPTACLE & FEED-THRU BOX	BOX ONLY	DOUBLE RECEPTACLE & DEAD END BOX	BOX ONLY	DOUBLE RECEPTACLE & FEED-THRU BOX	BOX ONLY
1/2"	KRS-215-120	SWB-1	KRS-218-120	SWB-4	2KRS-215-120	SWB-7	2KRS-218-120	SWB-10
3/4"	KRS-215-220	SWB-2	KRS-218-220	SWB-5	2KRS-215-220	SWB-8	2KRS-218-220	SWB-11
1"	KRS-215-320	SWB-3	KRS-218-320	SWB-6	2KRS-215-320	SWB-9	2KRS-218-320	SWB-12

RECEPTACLE ONLY – CATALOG NUMBER KRS-20

^① KRS Series receptacles - Class I, Group D.

^② SWB Series mounting splice boxes only for receptacles shown above listed in Section C of full-line catalog. See page PR22 for available polarization options.

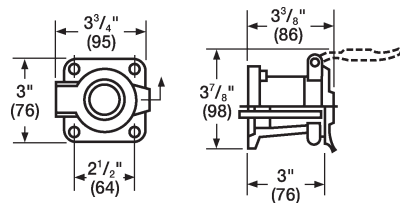

KRJ-Series



AJC



JLC



JLX

ELECTRICAL RATING	
CIRCUIT	RATING (60 HERTZ)
1Ø 2W3P	20 AMPS, 115/230 V.A.C., 1 H.P

KRJ RECEPTACLE WITH AJ OR JL BOX			
HUB SIZE	CATALOG NUMBER		
	AJC	JLC	JLX
1/2"	—	KRJC-120	KRJX-120
3/4"	KRAJC-220	KRJC-220	KRJX-220
1"	KRAJC-320	—	—
BACK BOX ONLY			
1/2"	—	JLC-1	JLX-1
3/4"	AJC-2	JLC-2	JLX-2
1"	AJC-3	—	—

RECEPTACLE ONLY – CATALOG NUMBER KRJ-20

JL Series boxes shown in Section F of full-line catalog. Refer to page headings for suitability of specific items. See page PR22 for available polarization options.